



HORECA

HOTEL, RESTAURANTE & CAFETARIA

în România numai prin

TOP-K

DISPLAY COUNTERS -

Models for CAFETERIA,
ICE-CREAM,
CHOCOLATES, BAKERY
and TAKE AWAY heated
and refrigerating

OPTIONAL EXTRAS

- 4 frontal glass designs: flat high (VDA), flat low (VDB), convex (VCV) and retro style (VP)
- Service top as SS, natural stone or Corian®
- Display deck as SS or Corian®
- Rear sliding perspex
- GN pans
- Swivel castors
- Tropicalized compressor unit
- Optional factory fit colours for interior and exterior

J✱RDAO COOLING SYSTEMS®

E-LINE TWIST





a padaria

E-LINE TWIST

versões & dados técnicos range & technical data
versions & donnés techniques | versiones & datos técnicos

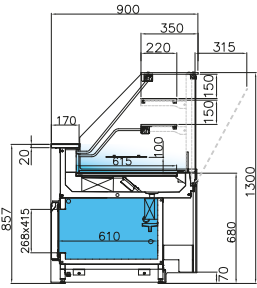

VELVT - VDA 3M2
ventilada total
total ventilated
ventilée totale
ventilada total

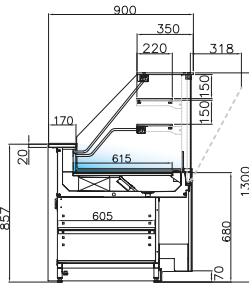

VELVS - VDA 3M2
ventilada superior
upper ventilated
ventilée supérieure
ventilada superior

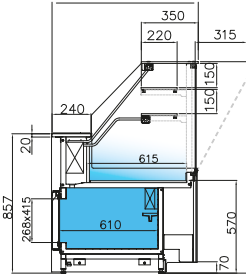

VELET - VDA 3M2
estática total
total static
statique totale
estatica total

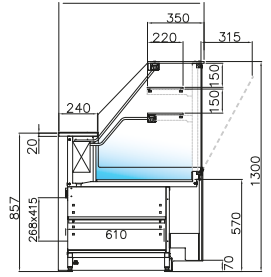

VELES - VDA 3M2
estática superior
upper static
statique supérieure
estatica superior

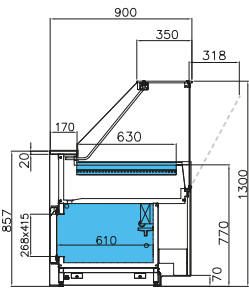

VELETRT - VDA 3M2
tampo refrigerado total
total refrigerated deck
plateau réfrigéré totale
tampo refrigerado total

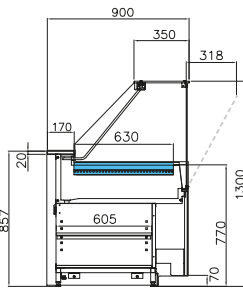

VELETRS - VDA 3M2
tampo refrigerado superior
upper refrigerated deck
plateau réfrigéré supérieure
tampo refrigerado superior

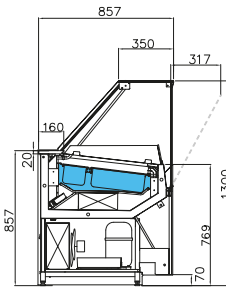

VELGL - VDA 3L1
gelados
ice cream
crème glacée
helados

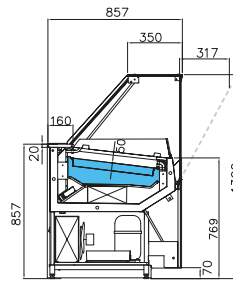

VELSF - VDA
semifrio
frozen desserts
entremets glacés
semi frio

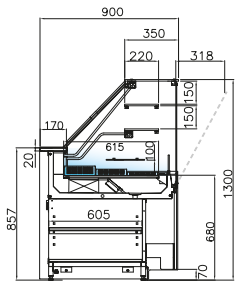

VELVCHS - VDA 3S
chocolates
chocolate
chocolat
chocolate

| Dados técnicos Technical data Donnés techniques Datos técnicos | VELVT(**) / VELVS 3M2 | | | | | | | | | | | | | |
|---|-----------------------|--------|---------|---------|-----------|-----------|-------|-------|-----------------------|-----------|-----------|--------------------|---------|---------|
| | 850 | 1250 | 1650 | 2050 | 2500 | CIR45 | CIR90 | CEC90 | CER90 | | | | | |
| Comprimento sem laterais Length without ends Longueur sans joues Ancho sin laterales | mm | -/850 | 1250 | 1650 | 2050 | 2500 | - | - | - | - | | | | |
| TDA - Superfície de exposição VDA Display area Surface d'exposition Superficie exposicion | m ² | -/0,49 | 0,73 | 0,96 | 1,19 | 1,45 | 0,84 | 1,68 | 1,18 | 1,18 | | | | |
| Potência frigorífica* Refrigeration power Puissance frigorifique Potencia frigorifica | W | -/531 | 531 | 855 | 855 | 1034/855 | 531 | 531 | 531 | 531 | | | | |
| Potência nominal máxima 230V~/50Hz Rated power Puissance nominale Potencia nominal | W | -/729 | 768/776 | 952/956 | 1003/1007 | 1158/1060 | 408 | 432 | 432 | 567 | | | | |
| Temp. de func. (T.Amb. = 25°C H.R. = 60%) Working temp. Temp. de fonctionnement Temp. de funcionamiento | °C | 2/4 | 2/4 | 2/4 | 2/4 | 2/4 | 2/4 | 2/4 | 2/4 | 2/4 | | | | |
| Dados técnicos Technical data Donnés techniques Datos técnicos | VELET / VELES 3M2 | | | | | | | | VELETRT / VELETRS 3M2 | | | VELGL 3L1 / VELGSF | | |
| | 850 | 1250 | 1650 | 2050 | 2500 | CIR90 | CIR45 | 850 | 1250 | 1650 | 850 | 1250 | 1650 | |
| Comprimento sem laterais Length without ends Longueur sans joues Ancho sin laterales | mm | -/850 | 1250 | 1650 | 2050 | 2500 | - | - | -/850 | 1250 | 1650 | 850 | 1250 | 1650 |
| TDA - Superfície de exposição VDA Display area Surface d'exposition Superficie exposicion | m ² | -/0,49 | 0,73 | 0,96 | 1,19 | 1,45 | 1,68 | 0,84 | 0,69 | 0,68/1,03 | 0,90/1,37 | 6*5L | 10*5L | 13*5L |
| Potência frigorífica* Refrigeration power Puissance frigorifique Potencia frigorifica | W | -/281 | 471/281 | 471 | 855 | 855 | 471 | 471 | 281 | 471 | 471 | 375 | 753 | 989 |
| Potência nominal máxima 230V~/50Hz Rated power Puissance nominale Potencia nominal | W | -/520 | 678/558 | 748/733 | 870/921 | 898/961 | 846 | 727 | 551 | 779/743 | 794/758 | 1254 | 2002 | 2453 |
| Temp. de func. (T.Amb. = 25°C H.R. = 60%) Working temp. Temp. de fonctionnement Temp. de funcionamiento | °C | 2/4 | 2/4 | 2/4 | 2/4 | 2/4 | 2/4 | 2/4 | 2/4 | 2/4 | 2/4 | -20/-18 | -20/-18 | -20/-18 |
| | | | | | | | | | | | | -10/-8 | -10/-8 | -10/-8 |

(*) T. Evap. -10°C / T. Cond. +45°C | T. Evap. -30°C / T. Cond. +45°C (VELGL)

(**) Versões em canto não disponível | corner models not available



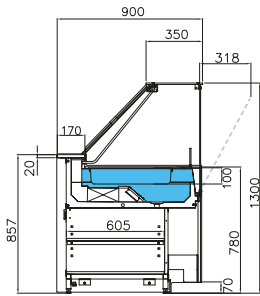

VELVLS - VDA 3M2
saladas
salads
salades
ensaladas

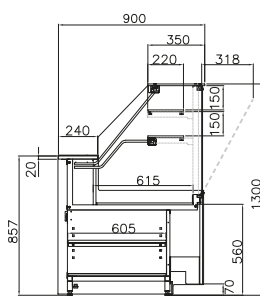

VELNT - VDA
neutra
neutral
neutre
neutra

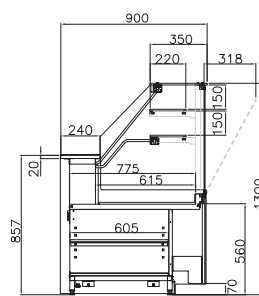

VELNA - VDA
neutra aberta
neutral opened
neutre ouverte
neutra abierta

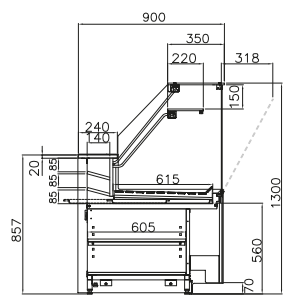

VELP - VDA
padaria
bakery
boulangerie
panadería

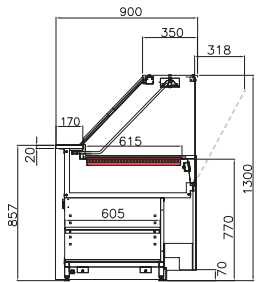

VELTA - VDA
tampo aquecido
heated deck
plateau chaud
tampo caliente

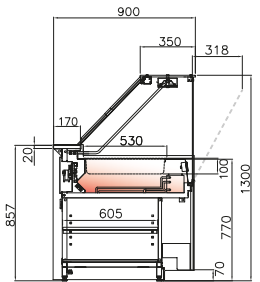

VELAQCH - VDA
aquecida ventilada c/ humidade
ventilated dry heated w/ humidity
chaude ventilée avec humidité
caliente ventilada con humedad

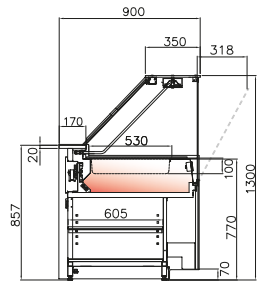

VELAQV - VDA
aquecida ventilada
ventilated dry heated
chaude ventilée
caliente ventilada

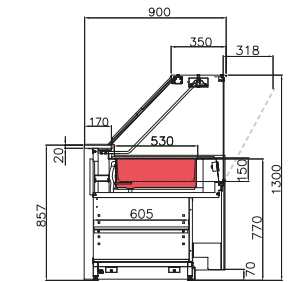

VELBM - VDA
banho-maria
bain marie
bain-marie
baño maria

| Dados técnicos Technical data Donnés techniques Datos técnicos | VELVCHS 3S | | | VELVLS 3M2 | | | VELP | | | | | |
|--|----------------|-------|-------|------------|---------------------|---------------------|---------------------|-------|-------|-------|-------|--|
| | 850 | 1250 | 1650 | 850 | 1250 | 1650 | 850 | 1250 | 1650 | | | |
| Comprimento sem laterais Length without ends Longueur sans joues Ancho sin laterales | mm | 850 | 1250 | 1650 | 850 | 1250 | 1650 | 850 | 1250 | 1650 | | |
| TDA - Superfície de exposição VDA Display area Surface d'exposition Superficie exposición | m ² | 0,49 | 0,73 | 0,96 | 2*GN1/1+ 3*GN1/9 | 3*GN1/1+ 3*GN1/6 | 4*GN1/1+ 3*GN1/6 | 0,9 | 1,32 | 1,74 | | |
| Potência frigorífica* Refrigeration power Puissance frigorifique Potencia frigorífica | W | 531 | 531 | 855 | 471 | 471 | 855 | - | - | - | | |
| Potência nominal máxima 230V~/50Hz Rated power Puissance nominale Potencia nominal | W | 811 | 1271 | 1166 | 667 | 733 | 921 | 35 | 59 | 76 | | |
| Temp. de func. (T. Amb. = 25°C H.R. = 60%) Working temp. Temp. de fonctionnement Temp. de funcionamiento | °C | 13/15 | 13/15 | 13/15 | 3/6 | 3/6 | 3/6 | - | - | - | | |
| Dados técnicos Technical data Donnés techniques Datos técnicos | VELNT / VELNA | | | | | | | | | | | |
| | 850 | 1250 | 1650 | 2050 | 2500 | CIR45 | CIR90 | CEC45 | CEC90 | CER90 | CER45 | |
| Comprimento sem laterais Length without ends Longueur sans joues Ancho sin laterales | mm | 850 | 1250 | 1650 | 2050 | 2500 | - | - | - | - | - | |
| TDA - Superfície de exposição VDA Display area Surface d'exposition Superficie exposición | m ² | 0,49 | 0,73 | 0,96 | 1,19 | 1,45 | 0,84 | 1,68 | 0,59 | 0,95 | 1,18 | |
| Potência frigorífica* Refrigeration power Puissance frigorifique Potencia frigorífica | W | - | - | - | - | - | - | - | - | - | - | |
| Potência nominal máxima 230V~/50Hz Rated power Puissance nominale Potencia nominal | W | 49 | 87 | 111 | 135 | 175 | 24 | 62 | 24 | 84 | 56 | |
| Temp. de func. (T. Amb. = 25°C H.R. = 60%) Working temp. Temp. de fonctionnement Temp. de funcionamiento | °C | - | - | - | - | - | - | - | - | - | - | |

(*) T. Evap. -10°C / T. Cond. +45°C

(**) Versões em canto não disponível | corner models not available



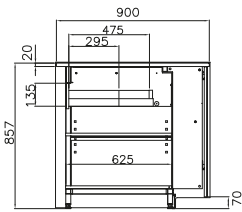

CX1NEL
caixa
support counter
caisse
caja

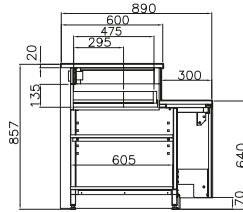

CX2NEL
caixa
support counter
caisse
caja

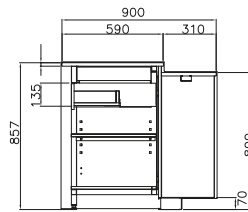

CXPMREL
caixa PMR
PRM counter
caisse PMR
caja PMR

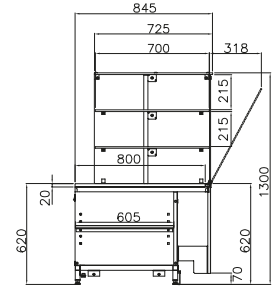

ELTV - VDA
torre de vidro
tower glass
tour vitrée
torre de vidro

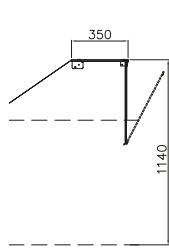

OPÇÃO: VDB
vidro direito baixo
low flat frontal glass
vitrage droit bas
vidrio reto bajo

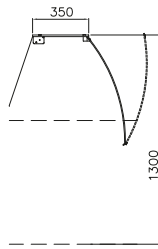

OPÇÃO: VCV
vidro convexo
curved frontal glass
vitrage convexe
vidrio curvo

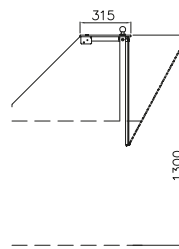

OPÇÃO: VP
vidro com postes
flat retro frontal glass
vitrage rétro droit
vidrio con postes

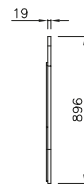

19mm
lateral
side panel
jouis
lateral

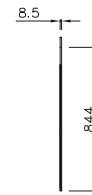

8,5mm
lat. de acoplamento
coupling panel
joue d'assemblage
lat. de acoplamiento

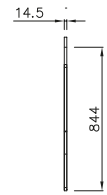

14,5mm
lat. de acoplamento
coupling panel
joue d'assemblage
lat. de acoplamiento

| Dados técnicos Technical data Donnés techniques Datos técnicos | VELBM | | | VELTA | | | VELAQV / VELAQCH | | | |
|--|----------------------|---------|----------------------|----------------------|-------|--------|------------------|-----------|-----|--------|
| | 850 | 1250 | 1650 | 850 | 1250 | 850 | 1250 | | | |
| Comprimento sem laterais Length without ends Longueur sans joues Ancho sin laterales | mm | 850 | 1250 | 1650 | 850 | 1250 | 850 | 1250 | | |
| TDA - Superfície de exposição VDA Display area Surface d'exposition Superficie exposicion | m ² | 2*GN1/1 | 3*GN1/1 + 3*GN1/6 | 4*GN1/1 + 3*GN1/6 | 0,48 | 0,73 | 0,90 | 1,32 | | |
| Potência frigorífica* Refrigeratrion power Puissance frigorifique Potencia frigorifica | W | - | - | - | - | - | - | - | | |
| Potência nominal máxima 230V~/50Hz Rated power Puissance nominale Potencia nominal | W | 2013 | 3535 | 3785 | 736 | 1021 | 1043/1543 | 1835/2335 | | |
| Temp. de func. (T. Amb. = 25°C H.R. = 60%) Working temp. Temp. de fonctionnement Temp. de funcionamiento | °C | 60/65 | 60/65 | 60/65 | 60/65 | 60/65 | 60/65 | 60/65 | | |
| Dados técnicos Technical data Donnés techniques Datos técnicos | CX1NEL / CX2NEL (**) | | | | | | CXPMREL | ELTV | | |
| | 515 | 850 | CIC45 | CIR90 | CEC45 | CEC90° | CER90 | 1030 | 515 | 1030 |
| Comprimento sem laterais Length without ends Longueur sans joues Ancho sin laterales | mm | 515 | -/850 | - | - | - | - | 1030 | 515 | 1030/- |
| TDA - Superfície de exposição VDA Display area Surface d'exposition Superficie exposicion | m ² | - | - | - | - | - | - | - | - | - |
| Potência frigorífica* Refrigeratrion power Puissance frigorifique Potencia frigorifica | W | - | - | - | - | - | - | - | - | - |
| Potência nominal máxima 230V~/50Hz Rated power Puissance nominale Potencia nominal | W | 13 | -/21 | - | - | - | - | 26 | 12 | 26 |
| Temp. de func. (T. Amb. = 25°C H.R. = 60%) Working temp. Temp. de fonctionnement Temp. de funcionamiento | °C | - | - | - | - | - | - | - | - | - |

(*) T. Evap. -10°C / T. Cond. +45°C

(**) Versões em canto apenas disponiveis CEC90, CEC45, CIR90, CIR45 e CER45 | corner models only available CEC90, CEC45, CIR90, CIR45 and CER45





acabamentos finishes
finitions | acabados

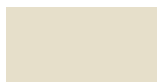

RAL 1013



RAL 1017



RAL 4009



RAL 5002



RAL 8017



Carvalho Claro
Bleached Oak
Chêne Blanchi
Roble Blanqueado



Carvalho Escuro
Dark Oak
Chêne Foncé
Roble Oscuro



Cerejeira
Cherry
Cerisier
Cerezo



Pereira
Pear
Poirier
Peral



Nogueira
Walnut
Noyer
Nogal



Bétula
Birch
Bouleau
Abédul

JORDAO COOLING SYSTEMS®

Parque Industrial, Pav. E1
4805-661 Ponte, Guimarães - Portugal
tel.: +351.253 470 700 - fax: +351.253 470 750
e-mail: geral@jordao.com - www.jordao.com



Obrigado pelo seu interesse nos nossos produtos; certifique-se de que esta informação é atual e válida.

Os dados apresentados nesta brochura poderão sofrer alterações após a sua publicação em março 2019. A JORDÃO ressalva modificações na construção, formato, aspeto e características técnicas dos seus equipamentos, opcionais e acessórios. Possíveis alterações nas cores reproduzidas devem-se à técnica de impressão. As ilustrações contêm elementos opcionais e acessórios. Todos os dados relativos ao equipamento são fornecidos a título meramente indicativo, para obtenção de informação atualizada deve contactar os representantes oficiais da marca JORDAO COOLING SYSTEMS.

Thank you for your interest in our products. Please make sure this information is up-to-date and valid.

The data presented in this brochure may be changed after its publication in March 2019. JORDAO safeguards construction, shape, appearance and technical characteristics modifications of its equipments, options and accessories. Possible changes in the reproduction of the colours are due to printing technique. The illustrations have optional elements and accessories. All data concerning the equipment is provided as information merely. To obtain up-to-date information you should contact JORDAO COOLING SYSTEMS official representatives.

Merci bien de votre intérêt par nos produits; assurez-vous que cette information est mise à jour et valide.

Les données présentées dans cette brochure pourront souffrir des altérations après sa publication en mars 2019. La société JORDAO sous réserve des modifications dans sa construction, forme, apparence et caractéristiques techniques de ses équipements, optionnels et accessoires. Changements possibles dans la reproduction des couleurs dues à la technique d'impression. Les illustrations contiennent des éléments en option et accessoires. Toutes les données concernant l'équipement sont fournies à titre indicatif. Pour obtenir des informations actualisées, veuillez contacter les représentants officiels de la marque JORDAO COOLING SYSTEMS.

Gracias por su interés en nuestros productos; verifique que esta información está actualizada y es válida.

Los datos presentados en ese catálogo pueden sufrir alteraciones posteriormente a su publicación en Marzo 2019. JORDAO se reserva modificaciones en construcción, formato, aspecto y características técnicas de sus equipos, opciones y accesorios. Las posibles alteraciones en los colores reproducidos se deben a la técnica de impresión. Las ilustraciones contienen elementos opcionales y accesorios. Todos los datos relativos al equipamiento son meramente orientativos, para obtener información actualizada debe contactar los representantes oficiales de la marca JORDAO COOLING SYSTEMS.



TOPK UTILAJE ALIMENTARE | Bd. Biruintei 49, Pantelimon, Ilfov, Romania, 077145 | Tel +40 21 350 20 34

Cod Fiscal: RO11687229 CUI: J23/3664/2013

Email: info@topk.ro Website: www.topk.ro